

PRODUCT NUMBER	REMARKS
88973-101LF	SOLDER TO BOARD
88973-111LF	PRESS FIT

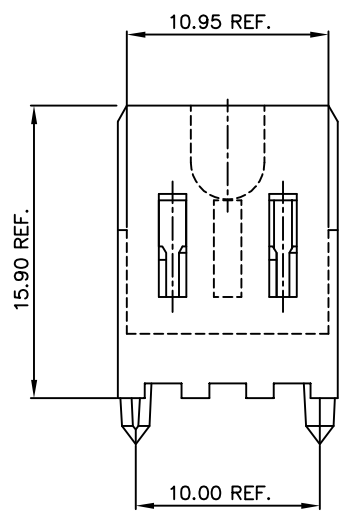

These holes are required when a shroud is used

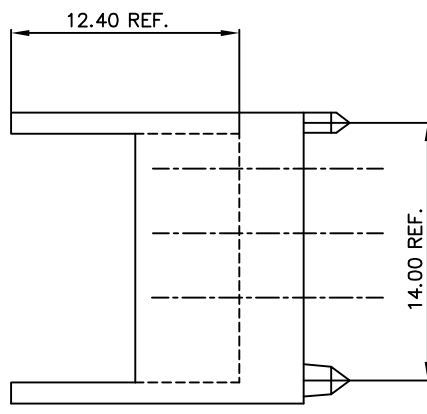
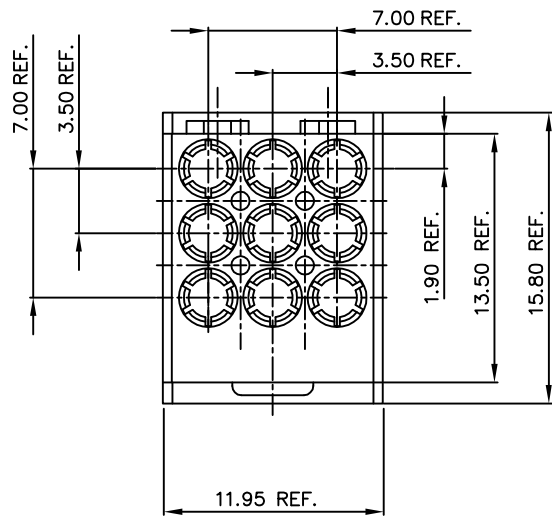
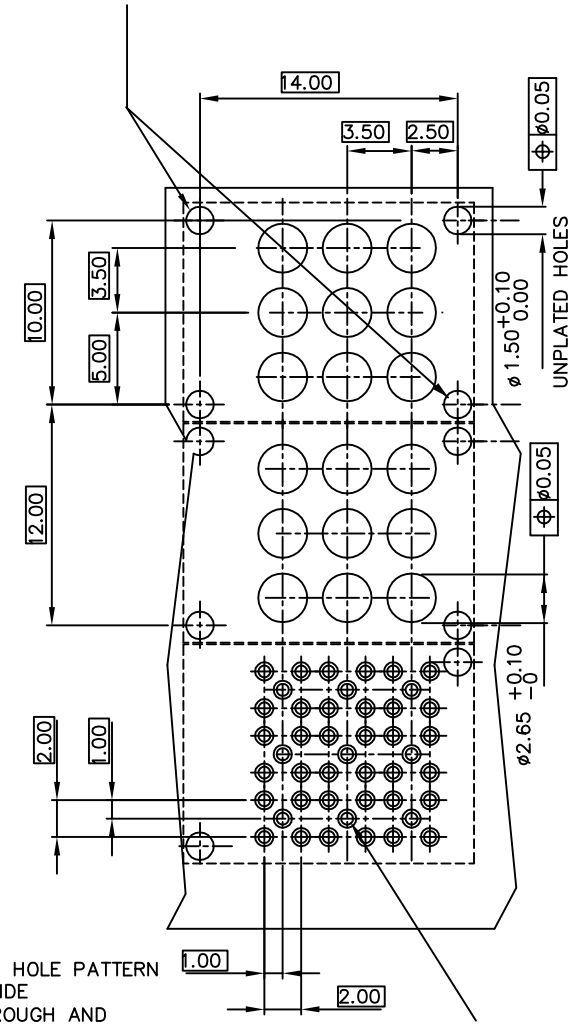

RECOMMENDED HOLE PATTERN COMPONENT SIDE FOR FEED THROUGH AND SOLDER TO BOARD.

- NOTES:
- MATERIAL:  
THERMOPL. POLYESTER 30% GLASS FLAME RETARDANT ACC. UL 94-V0 COLOR NATURAL.
  - WHEN USING THIS PRODUCT IN A STRAIGHT TO BOARD APPLICATION THE FOLLOWING MUST BE TAKEN INTO ACCOUNT:  
-101LF HOUSING IS TO BE USED FOR THE SOLDER TO BOARD INSERT 88980-00ZLF.  
-111LF HOUSING IS TO BE USED FOR THE PRESS FIT TO BOARD INSERT 88978-001LF.

- THIS PRODUCT MEETS EUROPEAN UNION DIRECTIVES AND OTHER COUNTRY REGULATIONS AS DESCRIBED IN GS-22-008.
- THE HOUSING WILL WITHSTAND EXPOSURE TO 260 DEGREE PEAK TEMPERATURE FOR 10 SECONDS IN A WAVE SOLDER APPLICATION WITH A 1.6mm MINIMUM THICK CIRCUIT BOARD.

mat'l. code		tolerances unless otherwise specified		CUSTOMER COPY		ELECTRONICS	
SEE NOTE 1				COPY		www.fciconnect.com	
ltr	ecm no	dr	date	linear	projection	title	
A	H10348	DAN	920424			HEADER MINI COAX	
B	H20755	DAN	921124			STRAIGHT 3x3	
C	H60040	RVI	960119	angles			
D	H70112	RMA	970218	dr	D Andrews	920424	product family
E	H90476	DOB	990816	eng	D Andrews	920424	size
F	pc05-0438	CLU	051102	chr	P Schalk	920424	dwg no
				app	H Cooljmans	960119	scale
sheet	revision	F					5:1
index	sheet	1					A2
							88973
							213
							sheet
							1 of 1

All rights reserved. Reproduction or use in other products is not permitted without written authority from the proprietor. Property of FCI Inc.