

SIZE	Part Num.	Threading	Packaging(see notes1&2)
25	8655MHRA2501LF	UNC 4.40	BULK (see note 1)
	8655MHRA2501KLF	UNC 4.40	KIT (see note 2)
	8655MHRA2502LF	M3	BULK
	8655MHRA2502KLF	M3	KIT

NOTES:

Material and finish: Zinc die-cast
Nickel plated

Cable strain relief: Steel fibre reinforced
Polycarbonate (UL94V-0)
for EMI/RFI screening

Jackscrow: Metal, threading according table
Temperature range: -40°C to 120°C
Cable diameter: 4,0 to 13,0mm
Attenuation factor: >40 dB between 30MHz and 1 GHz
Marking FCI logo: Height 6 mm for all versions

Covers screwing force (max): 100 Ncm
Jackscrow screwing force (max): 75 Ncm

Packaging notes (see tables):

- 1 - Bulk : Every spare part packaged per 100 or 200 into plastic bag. 5 plastic bags per carton box. 1 plastic bag per part.
- 2 - Kit : 1 set of spare parts necessary to realise 1 kit into a plastic bag. 100 plastic bags per carton box.

NOTE:RoHS INFORMATIONS

- The "LF" product meets European union Directives and other country regulations as described in GS-22-008.
- The product is not intended to be exposed to a manufacturing solder process.
- Packaging spec: see GS-14-920.

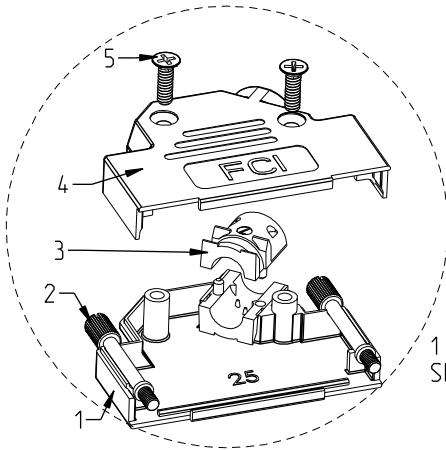
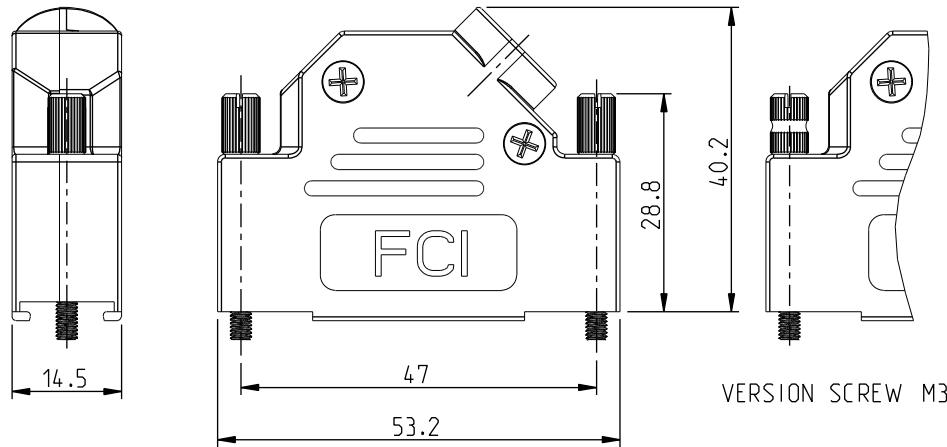

1 KIT
SEE NOTE 2

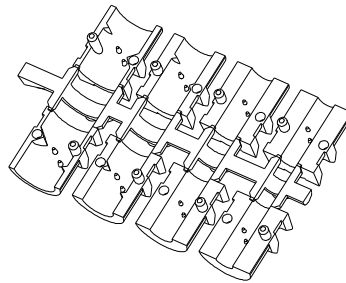

DESIGNATION	REP.	09	15	25	37	50
COVER BOTTOM	1			1		
JACKSCREW	2	1			2	
STRAIN RELIEF	3			2		
COVER TOP	4			1		
SCREW POZIDRIVE	5			2		

Rev	ecn no	dr	date
A	LS05-0086	MPE	2005/10/15
B	LS06-0084	LGO	2006/06/20
C	LS07-0096	LGO	2007/04/04
D	F09-0223	LSA	2009/11/24
E	F09-0236	LSA	2009/12/22
F	F10-0093	APA	2010/08/31
G	F10-0213	LSA	2010/19/15

www.fciconnect.com		surface ISO 1302	tolerance std ISO 406 ISO 1101	projection mm	
		TOLERANCES UNLESS OTHERWISE SPECIFIED			
Dr	BART.S	2005/10/15	ANGULAR	LINEAR	mm
Eng	LENOIR.M	2005/10/15	0.x	±/	size A3 Scale 3:2
Chr	LEGARE.P	2005/10/15	0.xx	±/	ECN F10-0093
Appr	LEGARE.P	2005/10/15	0.xxx	±/	Spec ref
FCI		Title D-SUB METAL SHELLS		dwg no 10061512C Rev. G	
catalog no		ANGLED		CUSTOMER sheet 1 of 3	

SIZE	Part Num.	Threading	Packaging
09	8655MHRA0901LF	UNC 4.40	BULK (see note 1)
	8655MHRA0901KLF	UNC 4.40	KIT (see note 2)
	8655MHRA0902LF	M3	BULK
	8655MHRA0902KLF	M3	KIT

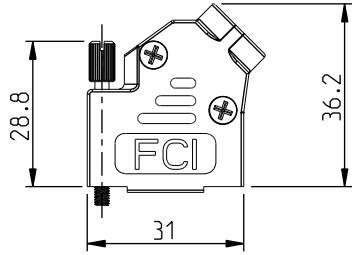
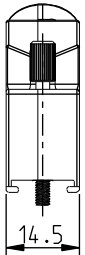

SIZE	Part Num.	Threading	Packaging
15	8655MHRA1501LF	UNC 4.40	BULK (see note 1)
	8655MHRA1501KLF	UNC 4.40	KIT (see note 2)
	8655MHRA1502LF	M3	BULK
	8655MHRA1502KLF	M3	KIT

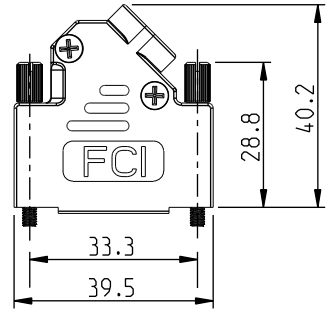
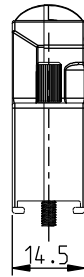

SIZE	Part Num.	Threading	Packaging
37	8655MHRA3701LF	UNC 4.40	BULK (see note 1)
	8655MHRA3701KLF	UNC 4.40	KIT (see note 2)
	8655MHRA3702LF	M3	BULK
	8655MHRA3702KLF	M3	KIT

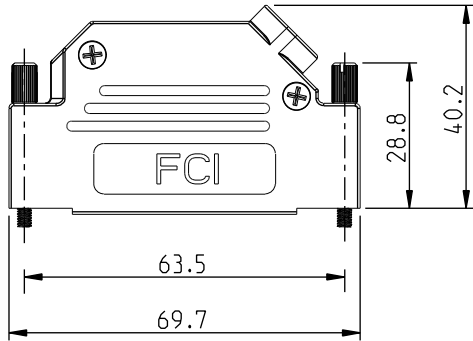
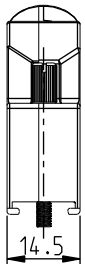

SIZE	Part Num.	Threading	Packaging
50	8655MHRA5001LF	UNC 4.40	BULK (see note 1)
	8655MHRA5001KLF	UNC 4.40	KIT (see note 2)
	8655MHRA5002LF	M3	BULK
	8655MHRA5002KLF	M3	KIT

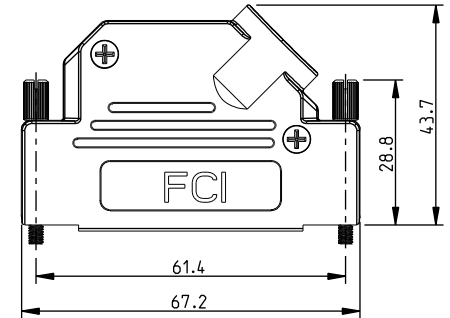
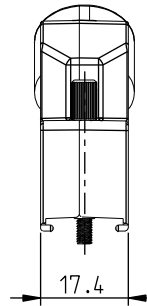

Copyright FCI.

C

D

REV C - 2006-03-28

www.fciconnect.com		surface ISO 1302	<input checked="" type="checkbox"/>	tolerance std ISO 406	ISO 1101	projection 	mm	
TOLERANCES UNLESS OTHERWISE SPECIFIED								
Dr	BART.S	2005/10/15	ANGULAR	LINEAR	0.x	±/	size A3	
Eng	LENOIR.M	2005/10/15			0.xx	±/	Scale 1:1	
Chr	LEGARE.P	2005/10/15	0° ±/°		0.xxx	±/	ECN F10-0093	
Appr	LEGARE.P	2005/10/15	Product family				Spec ref	
	Title D-SUB METAL SHELLS ANGLED					dwg no 10061512C		Rev. G
catalog no						CUSTOMER		sheet 2 of 3

CABLING INSTRUCTIONS

1- Use two halves of strain relief, different sizes can be mixed (Ø4, 5, 7 or 9)

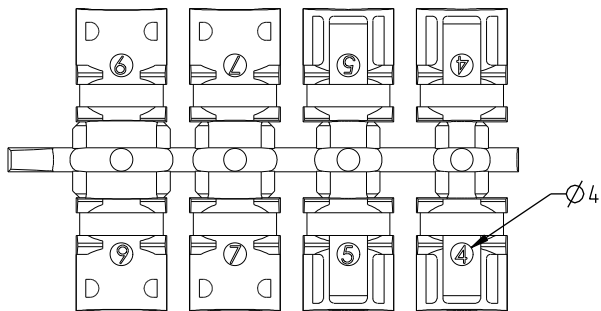

2- Strip cable 18mm and shape to two pigtails

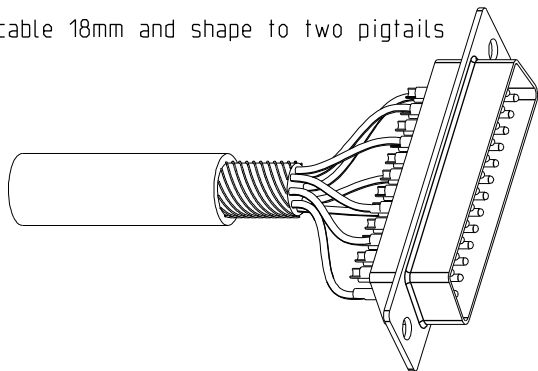

3- Attach the strain relief around the cable

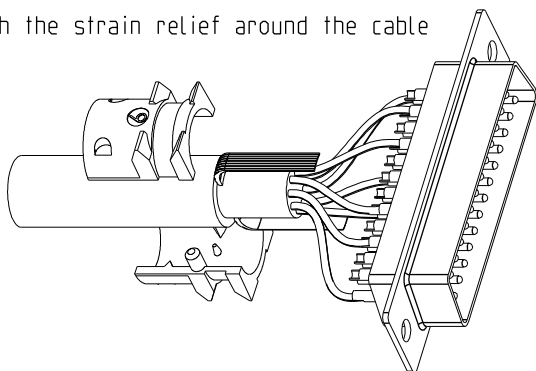

4- Bend cable shielding back on outside of strain relief

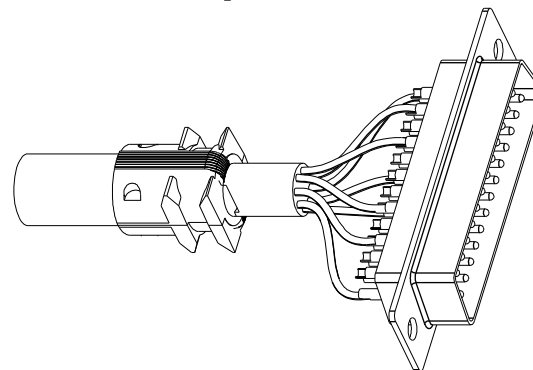

5- Mount connector and cable into the backshell

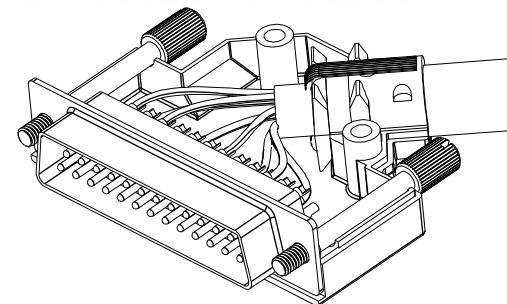

6- Assemble the other half screwing force: 100 Ncm

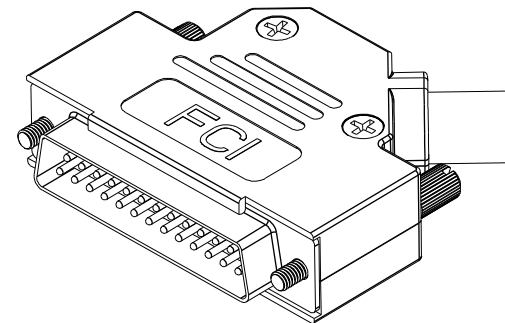

Copyright FCI.

www.fciconnect.com			surface ISO 1302	✓	tolerance std ISO 406 ISO 1101	projection mm	mm
TOLERANCES UNLESS OTHERWISE SPECIFIED							
Dr	BART.S	2005/10/15	ANGULAR	LINEAR	0.x	±/	size A3
Eng	LENOIR.M	2005/10/15			0.xx	±/	Scale 3:2
Chr	LEGARE.P	2005/10/15	0° ±/°		0.xxx	±/	ECN F10-0093
Appr	LEGARE.P	2005/10/15	Product family			Spec ref	
		Title D-SUB METAL SHELLS ANGLED			dwg no 10061512C		Rev. G
catalog no		CUSTOMER			sheet 3 of 3		