

PRODUCT NUMBER
20020107-XXXXXXLF

20020107- □ □ □ □ A O □ L F

PITCH
C: 3.50 mm
D: 3.81 mm
G: 5.00 mm
H: 5.08 mm

POLES
02: 2 POLES
03: 3 POLES
04: 4 POLES
24: 24 POLES

LF : DENOTED RoHS COMPATIBLE
1 : STANDARD PRODUCT
W/ BOX PACKING

HOUSING CODE		
CODE	COLOR	AVAILABILITY
1	GREEN(RAL 6018/T)	STANDARD
2	BLACK	ON REQUEST ONLY
3	GREY(RAL 7004/P)	ON REQUEST ONLY
4	BLUE(RAL 5015/A)	ON REQUEST ONLY

PROPERTY TABLE				
FCI SERIES NAME	06-350	06-381	06-500	06-508
PITCH (mm)	3.50	3.81	5.00	5.08
VOLTAGE RATING (VAC)	300	300	300	300
CURRENT RATING (A)	10	10	12	12
WITHSTANDING VOLTAGE (kV)	1.6	1.6	1.6	1.6
OPERATING TEMP. (°C)	-40~+115	-40~+115	-40~+115	-40~+115
SOLDERING TEMP. (°C)	250±10 (5 sec.)	250±10 (5 sec.)	250±10 (5 sec.)	250±10 (5 sec.)
POLES AVAILABLE	02~24	02~24	02~24	02~24
SAFETY CERTIFICATE				

- NOTES:
- MATERIALS
1-1 HOUSING: THERMALPLASTIC RESIN, UL 94V-0 RATED.
1-2 TERMINAL: COPPER, TIN PLATED.
 2. PRODUCTION SPECIFICATION REFER TO FCI GS-12-625.
 3. BOXED PACKAGING.
DETAILED PRODUCT PACKING SPECIFICATION REFER TO FCI GS-14-1394.
 4. FCI, SAFETY CERTIFICATE LOGO AND SERIES NAME TO BE SHOWN ON PRODUCT SURFACE.
 5. THE PRODUCTS WHERE THE PART NUMBER END IN "LF" MEET THE EUROPEAN UNION DIRECTIVE AND OTHER COUNTRY REGULATIONS AS DESCRIBED IN GS-22-008.
 6. RECOMENDED SOLDERING PROCESS BY WAVE SOLDER.

mat'l. code		surface ASME Y14.5 ✓		tolerance ASME Y14.5		projection		product family	
ltr		ecn no		dr		date		TERMINAL BLOCK	
A		DC09-0203		BF		062509		title	
B		T09-1148		BF		111709		TERMINAL BLOCK	
C		T09-1152		BF		112609		PLUGGABLE SOCKET, STRAIGHT	
D		T10-0042		WL		030310		dwg no	
E		T10-0159		WL		100410		sheet 1 of 5 size	
				dr		BEER FU		20020107	
				enr		BEER FU		A4	
				chr		GARY HSIEH			
				appd		JOSEPH HSIA		type	
								CUSTOMER Drawing	
sheet index		revision sheet		E		E		E	
		1 2		3		4		5	

PRODUCT NUMBER	SERIES NAME	PITCH
20020107-CXXXXXXLF	06-350	3.50 mm

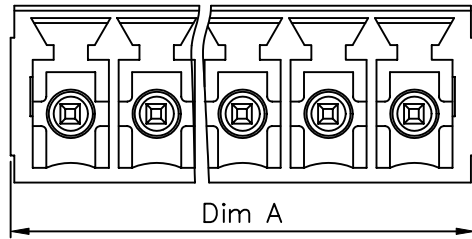

3.50
[0.138]

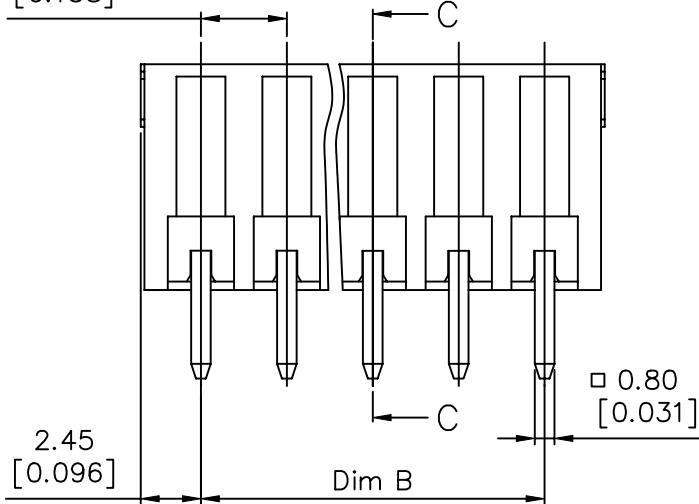

2.45
[0.096]

2.45
[0.096]

2.45
[0.096]

7.2
[0.28]

2.8
[0.11]

∅1.40
[∅0.055]

RECOMMENDED PCB LAYOUT

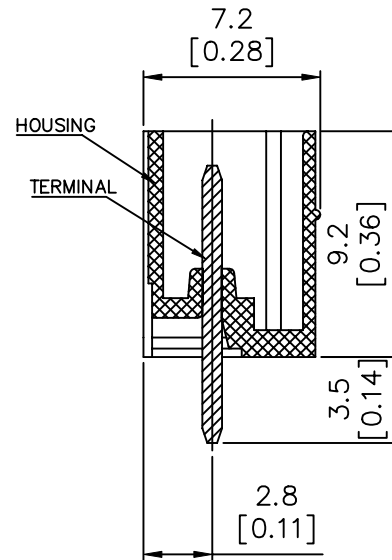

SECTION C-C

N = Number of poles
 Dim A = Dim B + 4.9 [0.193]
 Dim B = (N - 1) x 3.5 [0.138]

TOL.	Dim A	Dim B
2-6p	±0.15 [0.006]	
7-12p	±0.20 [0.008]	
13-18p	±0.25 [0.010]	
19-24p	±0.30 [0.012]	

mat'l. code		surface ASME Y14.5 ✓	tolerance ASME Y14.5	projection [Symbol]	product family TERMINAL BLOCK
ltr	ecn no	dr	date	title	
E				TERMINAL BLOCK PLUGGABLE SOCKET, STRAIGHT	
angles		∠	X.±0.5	MM [INCH]	scale
∠		X.X±0.3	X.XX±0.1		
dr	BEER FU	062509			dwg no
enr	BEER FU	062509			sheet 2 of 5
chr	GARY HSIEH	062509			20020107
appd	JOSEPH HSIA	062509			A4
sheet index	revision sheet			type	CUSTOMER Drawing



PRODUCT NUMBER	SERIES NAME	PITCH
20020107-DXXXXXXLF	06-381	3.81 mm

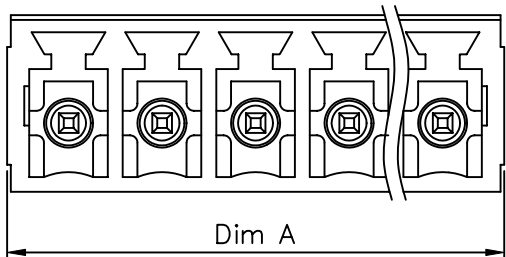

3.81
[0.150]

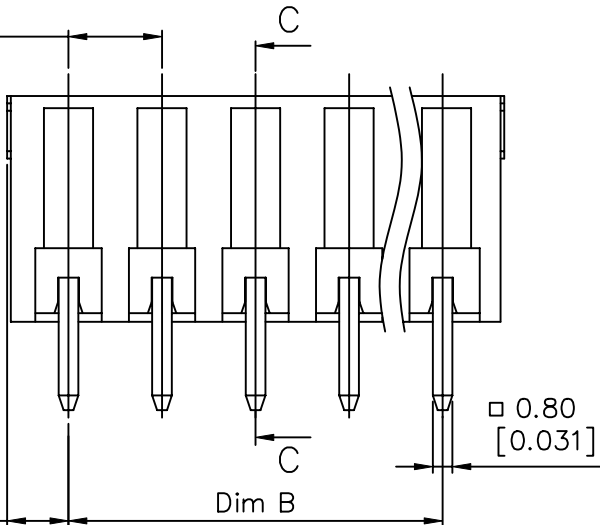

2.5
[0.098]

Dim B

□ 0.80
[0.031]

2.5
[0.098]

Dim B

2.5
[0.098]

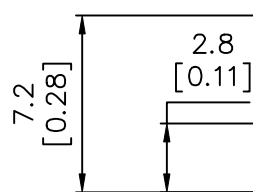

RECOMMENDED PCB LAYOUT

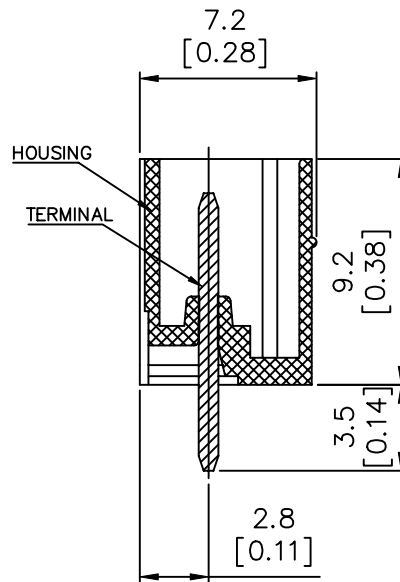

SECTION C-C

N = Number of poles
 Dim A = Dim B + 5.0 [0.197]
 Dim B = (N - 1) x 3.81 [0.150]

TOL.	Dim A	Dim B
2-6p	±0.15 [0.006]	
7-12p	±0.20 [0.008]	
13-16p	±0.25 [0.010]	
17-24p	±0.30 [0.012]	

mat'l. code		surface ASME Y14.5 ✓	tolerance ASME Y14.5	projection 	product family TERMINAL BLOCK
ltr	ecn no dr	date		tolerances unless otherwise specified	title
E				angles X ± 0.5 X.X ± 0.3 X° ± 1'	TERMINAL BLOCK PLUGGABLE SOCKET, STRAIGHT
				scale MM [INCH]	dwg no 20020107
		dr	BEER FU	062509	sheet 3 of 5 size
		enr	BEER FU	062509	A4
		chr	GARY HSIEH	062509	
		appd	JOSEPH HSIA	062509	type CUSTOMER Drawing
sheet index	revision sheet				





PRODUCT NUMBER	SERIES NAME	PITCH
20020107-GXXXXXLf	06-500	5.00 mm

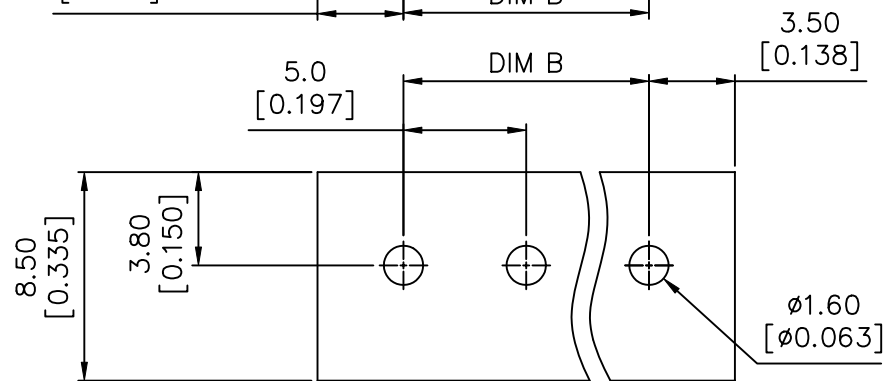
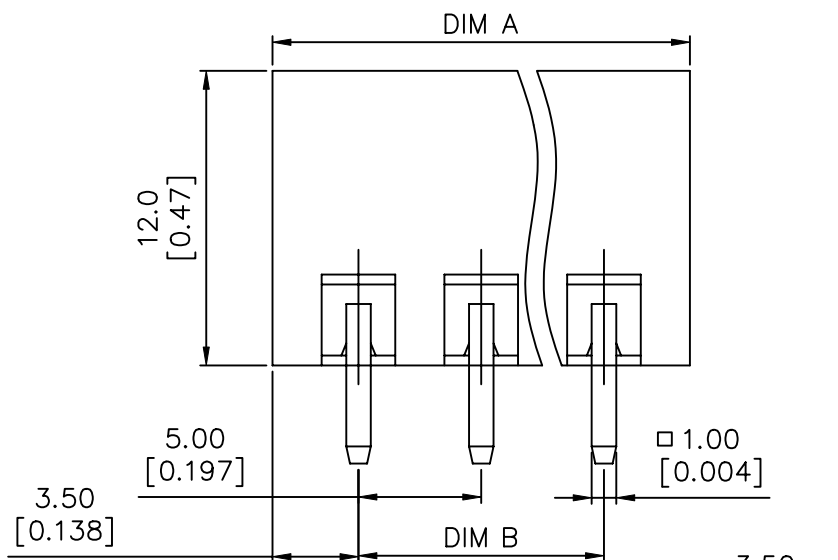
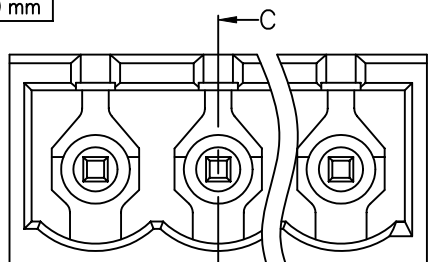

RECOMMENDED PCB LAYOUT

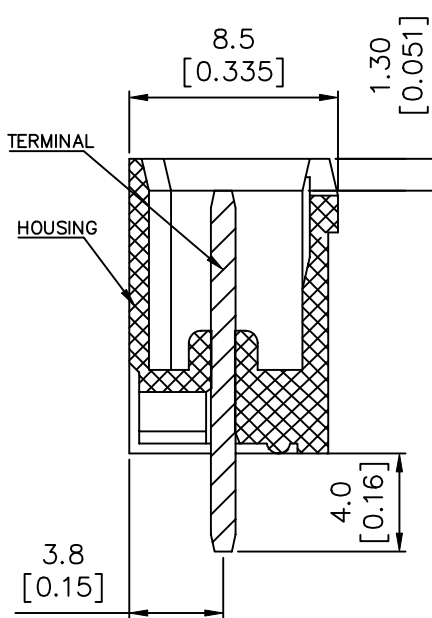

SECTION C-C

N = Number of poles
 Dim A = $N \times 5.0 [0.197] + 2.0 [0.193]$
 Dim B = $(N - 1) \times 5.0 [0.197]$

TOL.	Dim A	Dim B
2-6p	$\pm 0.15 [0.006]$	
7-12p	$\pm 0.25 [0.010]$	
13-16p	$\pm 0.35 [0.014]$	
17-24p	$\pm 0.40 [0.016]$	

mat'l. code		surface ASME Y14.5	tolerance ASME Y14.5	projection 	product family TERMINAL BLOCK
ltr	ecn no	dr	date	title	
E				TERMINAL BLOCK PLUGGABLE SOCKET, STRAIGHT	
angles		in	tol	MM [INCH]	scale
X°±1'			X.X±0.3		
			X.XX±0.1		
dr	BEER FU	062509	FCI		
enr	BEER FU	062509	dwg no 20020107 sheet 4 of 5 size A4		
chr	GARY HSIEH	062509	type CUSTOMER Drawing		
appd	JOSEPH HSIA	062509			
sheet index	revision sheet				



PRODUCT NUMBER	SERIES NAME	PITCH
20020107-HXXXXXXLF	06-508	5.08 mm

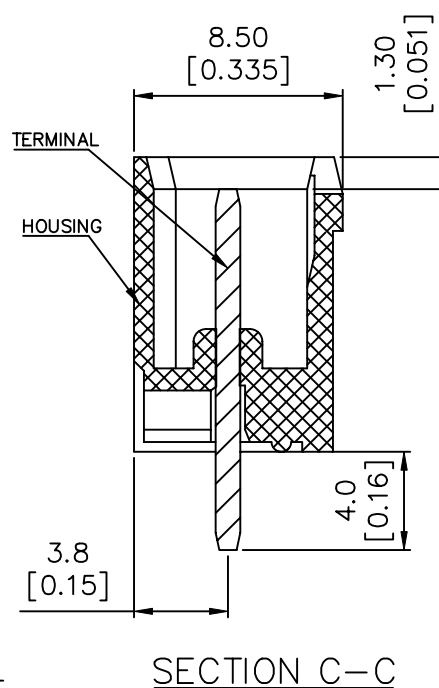
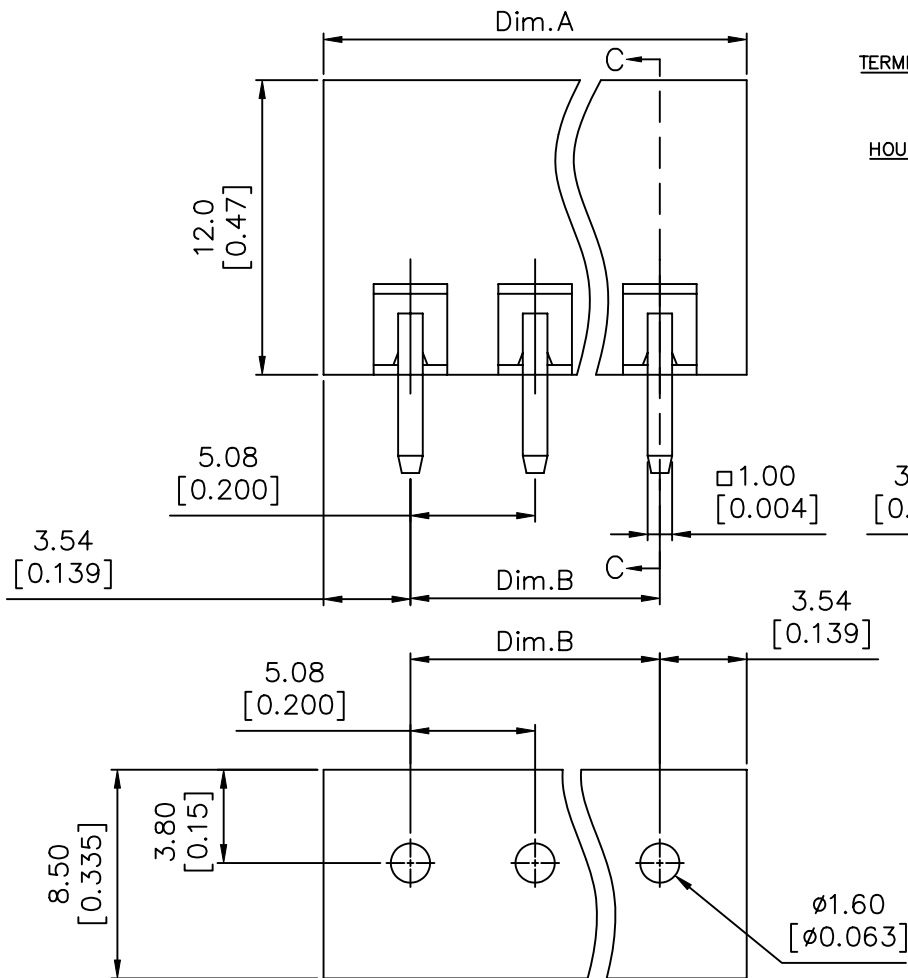
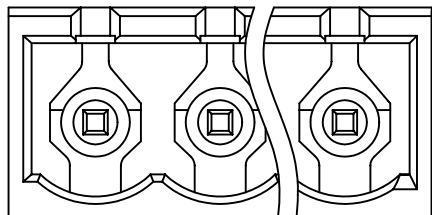

N = Number of poles
 Dim A = $N \times 5.08 [0.200] + 2.0 [0.193]$
 Dim B = $(N - 1) \times 5.08 [0.200]$

TOL.	Dim A	Dim B
2-6p	±0.15 [0.006]	
7-12p	±0.25 [0.010]	
13-18p	±0.35 [0.014]	
19-24p	±0.40 [0.016]	

RECOMMENDED PCB LAYOUT

mat'l. code		surface ASME Y14.5 ✓	tolerance ASME Y14.5	projection MM [INCH]	product family TERMINAL BLOCK
ltr	ecn no	dr	date	title TERMINAL BLOCK PLUGGABLE SOCKET, STRAIGHT	
E				dwg no 20020107	
				sheet 5 of 5 size A4	
				type CUSTOMER Drawing	
sheet index	revision sheet				

